

# V-CG-SLS 500

## LED Supply- and Monitoring Module



V-CG-SLS 500



Dimensions in mm

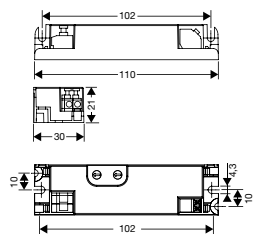

Module housing

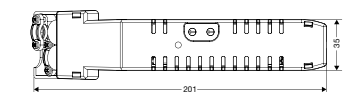
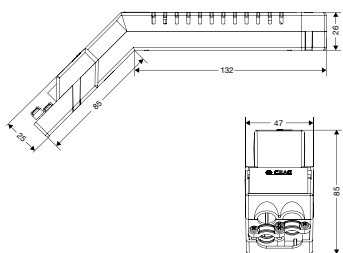

- Low operating costs due to decreased standby losses < 0.5 W
- Minimized dimensions on the basis of conventional T5 LCG cross section (H x W: 21 x 30 mm) for an eased mounting in narrow luminaires
- Without protective conductor connection. For the use in luminaires with insulation class I or II
- Variable mounting possibilities for different mounting positions (horizontal or sidewise upright)
- Avoidance of installation failures due to a mains connection being protected against polarity reversal
- Shortened inspection effort due to the **CEWA GUARD** Technology  
Automatic function monitoring of up to 20 luminaires per circuit
- Reduced installation costs due to **STAR-Technology**  
Freely programmable mixed operation of the switching modes per luminaire in one circuit
- Reduced installation expenditures as no additional data line to the luminaires is needed

### Primary side

Rated voltage ranges	220 - 240 V, 50 Hz / 176 - 275 V DC
Standby power losses	< 0.5 W (230 V / 50 Hz)
Current input	36 mA (230 V AC) / 21 mA (220 V DC)
Power input	8.2 VA (230 V AC)
Power factor $\lambda$	0.55
Inrush current	$\leq 1.5$ A
Operating frequency	132 kHz
EEL	A2
Connecting terminals	Plug-in terminals 2.5 mm <sup>2</sup> / reverse-polarity protected

### Secondary side

Output current	500 mA (constant current)
Output voltage	8.3 V DC (open-circuit operation)
Lamp load	2 x LED (rated current 500 mA), series connection
Output power (max.)	3.2 W
Connecting terminals	Plug-in terminals 1.5 mm <sup>2</sup> / <u>not</u> reverse-polarity protected

Maximum line length	1 m (module – LED)
Type of mounting	To be mounted in luminaires with protection category I or II
Degree of protection	IP 20
Ambient temperature range	$t_a = -20$ °C up to $+50$ °C
Maximal permissible test point temperature	$t_c = 70$ °C
Dimensions in mm (H x L x W)	21 x 110 x 30
Housing material / colour	Flame retardant polycarbonate / grey
Weight	0.042 kg
Rated luminous flux $\Phi_e$	100 % (at LED rated current)

### Ordering details

Scope of supply	Order-No.
V-CG-SLS 500	400 71 352 418
Module housing with strain relief	400 71 351 928